

LED HIGH BAY LIGHT

WARRANTY

1. 5-year warranty replacement warranty will be provided during the warranty period if the lamp suffers quality problems.
2. During the warranty period, the customer shall return the damaged goods or failed parts for inspection and repair by Goldenlux. Goldenlux will then send the fixed or new parts back.
3. A replacement warranty will be provided once valid documents are presented.

The following circumstances will not receive replacement warranty:

- ① Damage caused, including, but not limited to, damage from abnormal working conditions, improper usage, storage that does not conform to the instruction manual;
- ② Dismantling, modification or improper installation or repairing of the products without Goldenlux's authorization;
- ③ Damages caused by environmental circumstances including, but not limited to, fire, flood, lightning strike, earthquake.

WARNING

To avoid the risk of fire, explosion, or electric shock:

This product should be installed, inspected, and maintained by a qualified electrician only, in accordance with all applicable electrical codes.

* Verify power wire is by following per under applicable electrical codes.

& The light source contained in this luminaire shall only be replaced by the manufacturer or his service agent or a similar qualified person.

& The external flexible cable or cord of this luminaire cannot be replaced; if the cord is damaged, the luminaire shall be destroyed.

To avoid electric shock:

- Be certain electrical power is OFF before and during installation and maintenance.
- Luminaires must be supplied by a wiring system suitable per local code with an equipment grounding conductor.

To avoid burning hands:

- Before to performing maintenance, ensure Luminaire is allowed to cool after powering off for a period of 30 minutes.

To avoid product degradation:

- Do not operate in ambient temperatures above those indicated on the luminaire date sheet.
- Use proper supply wiring as specified on the luminaire date sheet.
- Avoid use in environments containing sulfur, chlorine or other halides, methyl acetate or ethyl acetate, cyanoacrylates, glycol ethers, formaldehyde, or butadiene.
- Mount luminaire no less than 36 inches from the ceiling.
- Make sure the supply voltage is within the voltage range stated on the date sheet.
- Use only replacement parts from Goldenlux.
- Aircraft cable mounting is recommended for dry locations only.
- Use only Goldenlux or equivalent parts for mounting luminaire.

MOUNTING

PENDANT EYEBOLT MOUNTING

STEP 1

Thread the enclosed eyebolt hook into the top of the luminaire housing, and tighten securely. Tighten the set screw to prevent the eyebolt from loosening.

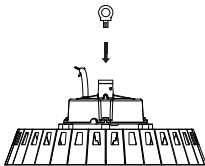

STEP 3

Refer to the Wiring Diagram to make electrical connections.

STEP 2

Use a chain, cable, mounting hook, or other mounting hardware to suspend the luminaire. Make sure the mounting hardware is securely attached to a stationary structure and strong enough to safely be attached to a stationary structure and strong enough to safely suspend the luminaire.

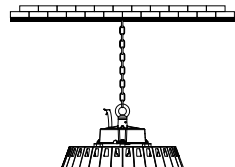

CEILING MOUNTING:

STEP 1

Punch M10 screw holes in the ceiling according to the bracket holes (as shown in Figure 6).

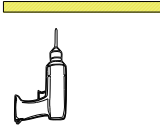

STEP 2

Align the bracket with the screw hole, tighten the screw and fix the bracket.

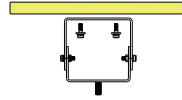

STEP 3

Align the hole at the top of the lamp with the bottom of the bracket, and tighten the screws to fix the lamp.

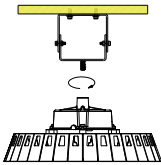

STEP 4

Tighten the screws at this position to complete the installation.

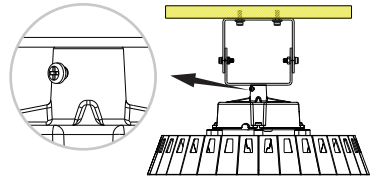

STEP 5

Unscrew the screw and adjust the lamp angle according to your needs Degree.

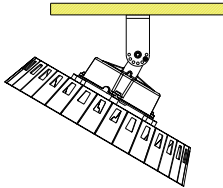

STEP 6

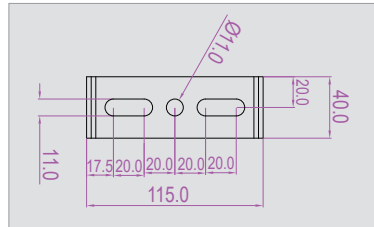

REFER TO THE WIRING DIAGRAM TO MAKE ELECTRICAL CONNECTIONS

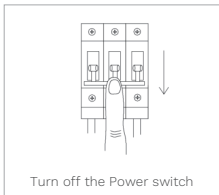

⚠ Connecting the cable requires an IP65 Tightness Level

CE	AC-L(Brown)	AC-N(Yellow Green)	AC-N(Blue)
UL	AC-L(Black)	AC-N(Green)	AC-N(White)

